

MOTOR FEATURES

REFERENCE NUMBER REFERENCIA REFERENZNUMMERN	NOMINAL VOLTAGE TENSION NOMINAL TENSION NOMINALE NENNSPANNUNG	NOMINAL TORQUE PAR NOMINAL COUPLE NOMINAL DREHMOMENT NOMINAL	NOMINAL SPEED VELOCIDAD NOMINAL VITESSE NOMINALE GESCHWINDIGKEIT NOMINAL	NOMINAL CURRENT CORRIENTE NOMINAL COURANT NOMINAL NOMINALSTROM	STARTING TORQUE PAR DE ARRANQUE COUPLE DE DEMARRAGE ANZUGSDREHMOMENT	STARTING CURRENT CORRIENTE DE ARRANQUE COURANT DE DEMARRAGE ANLAUFSTROM	SHAFT EJE ARBRE WELLE	CONNECTIONS CONEXIONES CONNEXIONS ANSCHLUSSART	WIRING DIAGRAM ESQUEMA ELECTRICO SCHEMA ELECTRIQUE SCHALTBILD	TRANSMISSION RATIO RELACION DE REDUCCION RAPPORT DE REDUCTEUR UNTERSETZUNG	APPROXIMATE WEIGHT PESO APROXIMADO POIDS APPROXIMATIF GEWICHT (ca.)	WATER TIGHTNESS GRADO DE ESTANQUEIDAD ETANCHEITE FEUCHTIGKEITSSCHUTZKLASSE	WHEEL MATERIAL MATERIAL RUEDA MATERIAU ROUE MAT. DES SCHNECKENRADES	CURVE CURVA COURBE KURVE
	Un (V)	Mn (N.m./lbf.in)	Fn (r.p.m.)	In (A)	Ma (N.m./lbf.in)	Ia (A)				i	P (kg/lb)	IP		
31727112000	12	4 / 35	25	2.5	12 / 106	8	E22	C30	EE4	62:1	1.15 / 2.54	IP10	PLA	64
31727113000	24	4 / 35	25	1.1	12 / 106	4	E22	C30	EE4	62:1	1.15 / 2.54	IP10	PLA	64
31727612000	12	4 / 35	25	2.5	12 / 106	8	E30	C30	EE4	62:1	1.15 / 2.54	IP10	PLA	64
31727613000	24	4 / 35	25	1.1	12 / 106	4	E30	C30	EE4	62:1	1.15 / 2.54	IP10	PLA	64
31727612000E	12	4 / 35	25	2.5	12 / 106	8	E30	C30	F4	62:1	1.15 / 2.54	IP10	PLA	64
31727613000E	24	4 / 35	25	1.1	12 / 106	4	E30	C30	F4	62:1	1.15 / 2.54	IP10	PLA	64

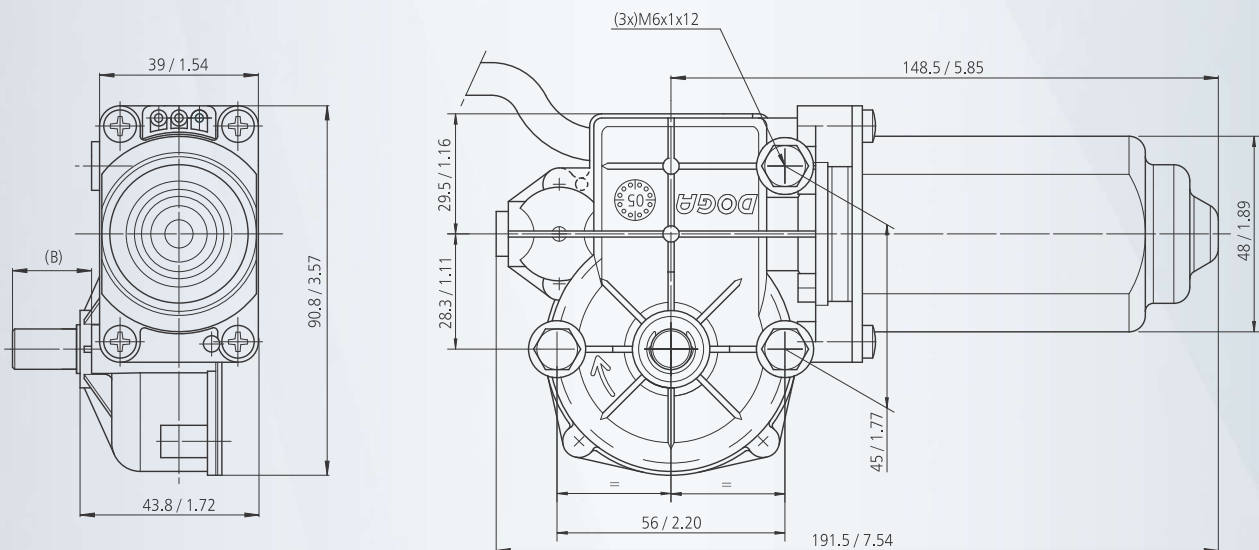

mm / inch

SHAFT EJE ARBRE WELLE

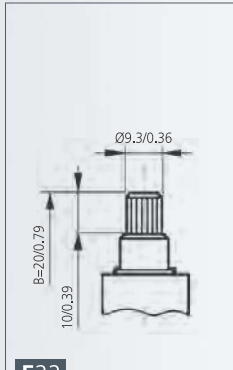

E22

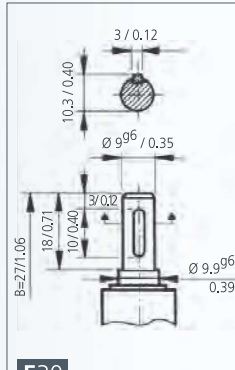

E30

CONNECTIONS **CONEXIONES** CONNEXIONS ANSCHLUSSART

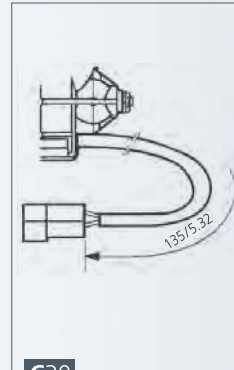

C30

CURVES **CURVAS** COURBES KURVEN

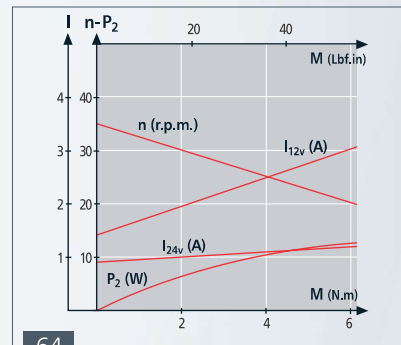

64

WIRING DIAGRAM **ESQUEMA ELÉCTRICO** SCHEMA ÉLECTRIQUE SCHALTBILD

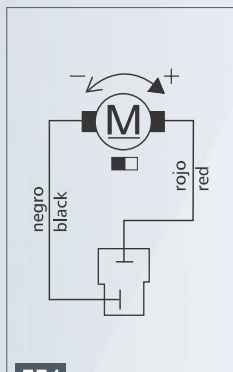

EE4

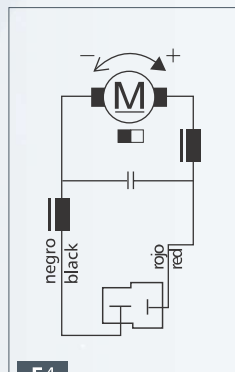

F4